

# Omnia

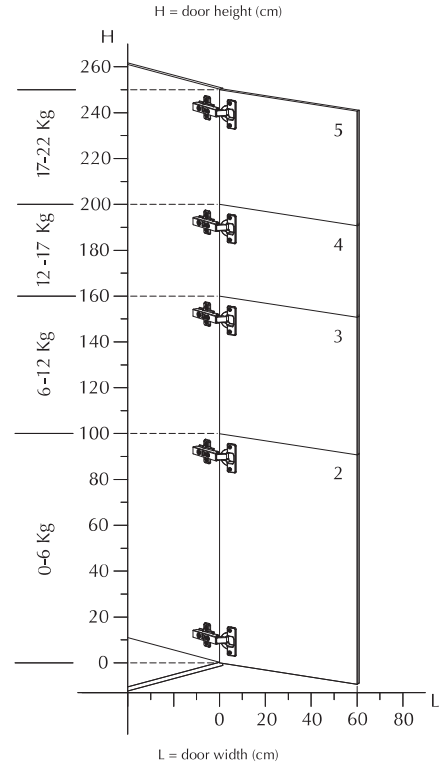

## AnyClickSystem

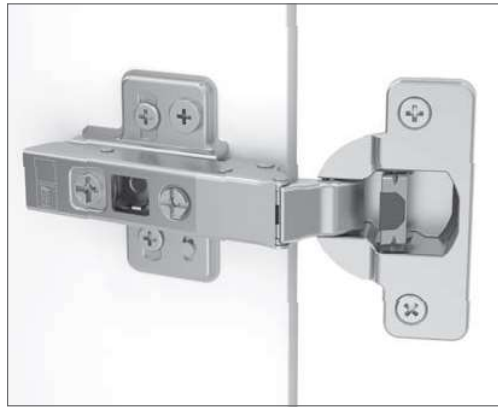

For an easy and quick fitting in any position.

## Adjusting System

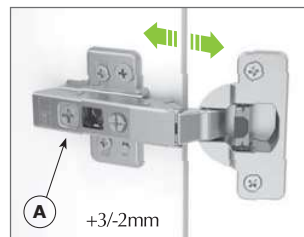

**Depth adjustment**  
Acting on the "A" screw it is possible to adjust the distance between the side of the cabinet and the door.

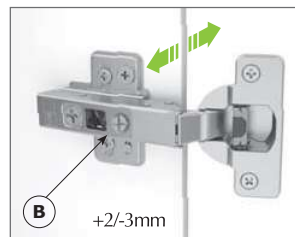

**Independent side adjustment**  
Acting on the "B" screw it is possible to change the amount of the door covering on the side of the cabinet.

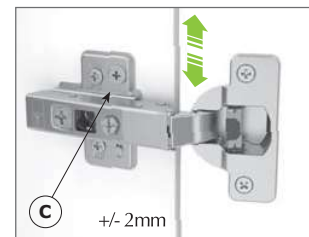

**Vertical adjustment**  
Acting on the "C" screw of the mounting plate it is possible to adjust the door vertically.

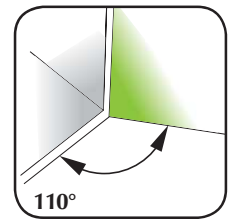
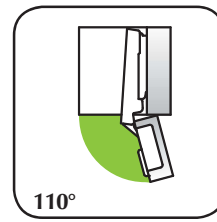

**CRANK 0**  
For lay-on doors

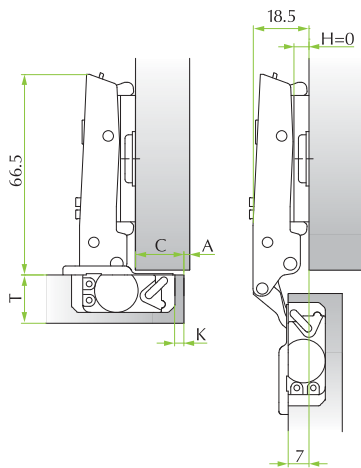

**CRANK 8**  
For partial lay-on doors

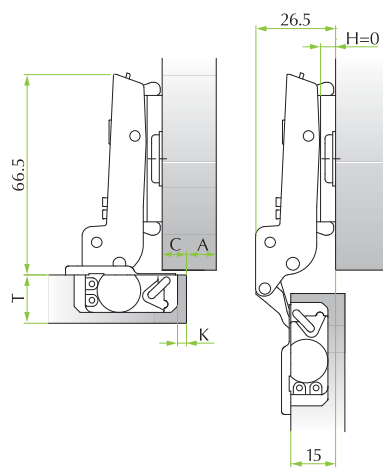

**CRANK 15**  
For inset doors

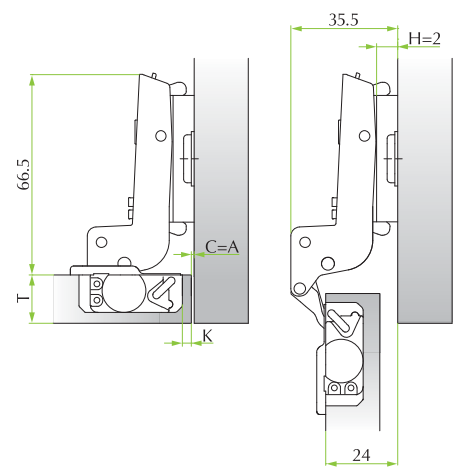

		Drilling distance (K)						
		3	4	5	6	7		
Overlay (C)	19				0			
	18			0		2		
	17		0		2			
	16	0		2		4		
	15		2		4			
	14	2		4		6		
	13		4		6			
	12	4		6				
	11		6					
	10	6						
		Mounting plates (H)						

		Drilling distance (K)						
		3	4	5	6	7		
Overlay (C)	11				0			
	10			0		2		
	9		0		2			
	8	0		2		4		
	7		2		4			
	6	2		4		6		
	5		4		6			
	4	4		6				
	3		6					
	2	6						
		Mounting plates (H)						

		Drilling distance (K)						
		3	4	5	6	7		
Overlay (C)	1	0		2		4		
	0		2		4			
	-1	2		4		6		
	-2		4		6			
	-3	4		6				
	-4		6					
-5	6							
		Mounting plates (H)						

Table to determinate the minimum distance **A** so that a door with **T** thickness can open without protrusion from the cabinet and without interfering with adjacent doors.

T=	16	17	18	19	20	21	22	23	24	25	26
K=3 A=	0.5	0.7	0.8	1.1	1.3	1.6	1.9	2.4	3.0	3.8	4.7
K=4 A=	0.5	0.7	0.8	1.1	1.3	1.5	1.8	2.2	2.6	3.4	4.2
K=5 A=	0.5	0.7	0.8	1.1	1.2	1.5	1.8	2.2	2.5	3.1	3.8
K=6 A=	0.5	0.7	0.8	1.0	1.2	1.4	1.7	2.1	2.4	2.9	3.5
K=7 A=	0.5	0.7	0.8	1.0	1.2	1.4	1.7	2.0	2.3	2.7	3.2